

BUILDING LOCATION SURVEY OF
PART OF LOT D, REGISTERED PLAN 792
CITY OF TORONTO
MUNICIPALITY OF METROPOLITAN TORONTO

Scale: 1:100 1988

LOT 16, REG'D PLAN 813
INST. NO. CT765200

Metropolitan Toronto Condo. Plan No. 608

LANE

PART 4

PL. 63R-3723

(DEDICATED AS PUBLIC HWY.
BY BY-LAW 59-87 (C784086C))

SUBJECT TO RIGHT OF WAY
ASPHALT

PART OF COMMON
PART 5, PLAN

ELEMENTS
63R-3723

INST. NO. CT755969
LOT 17

PART 3
PLAN

PART 2

PART 1
63R-3723

INST. NO. CT83884 6
INST. NO. CT83862

REG'D PLAN 813

REG'D PLAN

PLAN

792

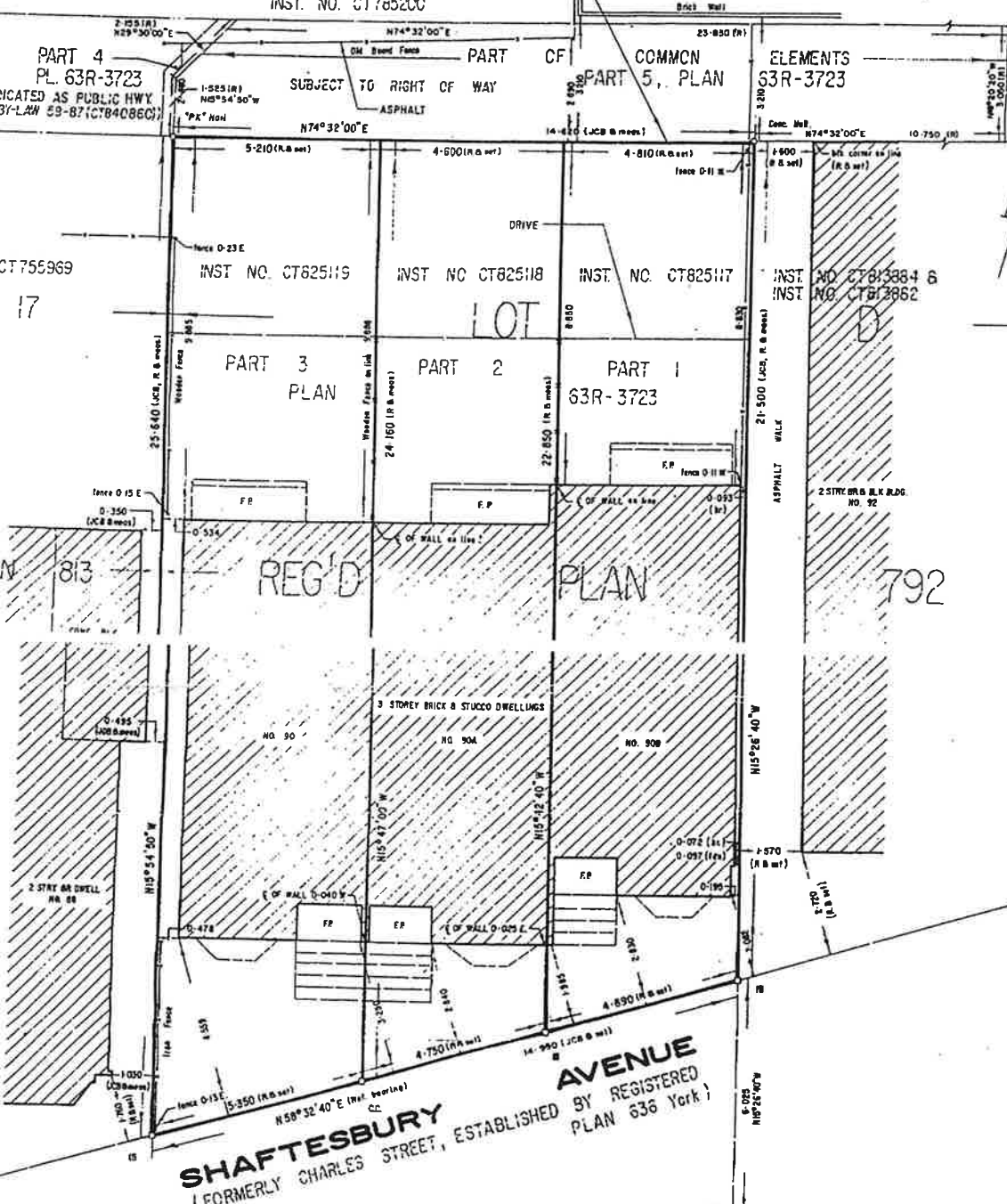

SHAFTESBURY AVENUE
(FORMERLY CHARLES STREET, ESTABLISHED BY REGISTERED PLAN 636 York)

NOTE

BEARINGS ARE ASTRONOMIC AND ARE REFERRED TO THE NORTHWESTERLY LIMIT OF SHAFTESBURY AVE., AS SHOWN ON PLAN 63R-3723, HAVING A BEARING OF N58°32'40\"/>

- DENOTES SURVEY MONUMENT SET
- FOUND
- STANDARD IRON BAR
- ▣ IRON BAR
- ✕ CUT CROSS
- CC. J.C. BEATSON O.L.S.
- (RI) PLAN 63R-3723

SURVEYOR'S CERTIFICATE

I CERTIFY THAT THE FIELD SURVEY REPRESENTED ON THIS PLAN WAS COMPLETED ON THE 18th DAY OF AUGUST, 1988.

DATE: AUGUST 22nd, 1988

Donald E. Roberts
DONALD E. ROBERTS
ONTARIO LAND SURVEYOR

METRIC:

DISTANCES SHOWN ON THIS PLAN ARE IN METRES AND CAN BE CONVERTED TO FEET BY DIVIDING BY 0.3048.

DONALD E. ROBERTS LTD., ONTARIO LAND SURVEYOR
1719 LAWRENCE AVENUE EAST, SCARBOROUGH, ONTARIO, M1R 2X7, 755-5320

DRAWN	J. r. h.	REF NO.
CHECKED	d. e. r.	
DATE	August 22, 1988	
SCALE	1:100	

86-2141